



Adjuster Strap Replacement Instructions

for Marathon™ & Wizard™

Items required:

- Scissors
- New adjuster strap

Overview: Front



Overview: Rear

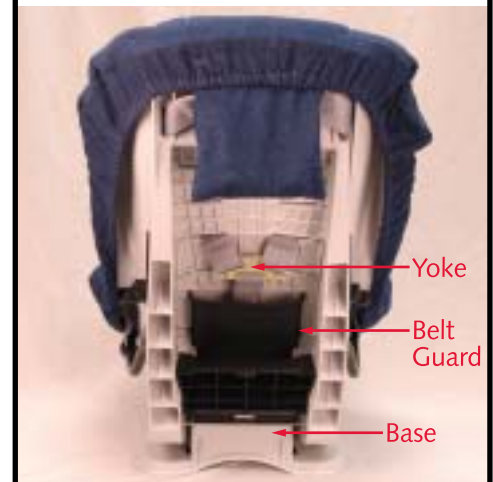

1 Cut old adjuster strap.



2 Completely loosen shoulder straps by lifting the adjuster lever while pulling the harness straps forward.
WIZARD ONLY: Fully raise headrest before proceeding.



3 From rear of seat, pull straps up to remove yoke from behind belt guard, then slide both shoulder straps off metal yoke.
4 Discard old adjuster strap.



5 Attach shoulder straps to yoke on new adjuster strap.

IMPORTANT: Attachment must be exactly as shown in photo for correct alignment. White tab must be toward seat.

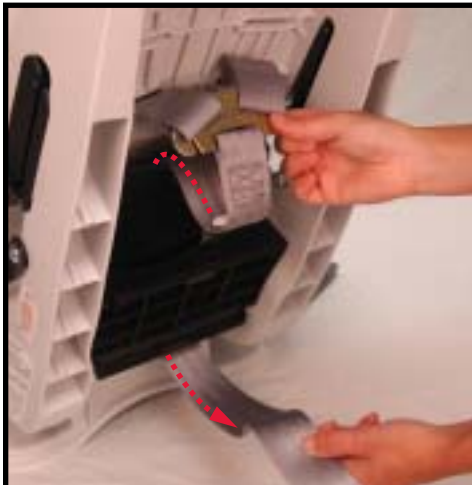

6 Drop loose end of adjuster strap between black belt guide and rear of seat.

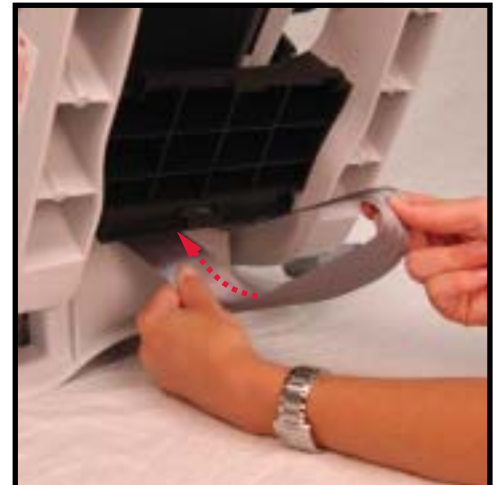

7 Route loose end of adjuster strap over base to the front.



8 Pull strap over base to the front of the restraint.



9 From the bottom of the seat, thread adjuster strap through slot behind adjuster to the top of the seat.
NOTE: To access bottom of adjuster area, lay seat on its back, with the base toward you.



10 Pull strap through completely.



11 Loop strap over, toward the front of the seat.



12 Lift adjuster lever and thread adjuster strap between metal bar and adjuster lever until paper tab is accessible from the front of the adjuster.



13 Continue to lift adjuster lever and use paper tab to assist pulling strap completely through adjuster.



14 Verify that adjuster strap is routed properly, as shown above.

15 Verify that shoulder straps and the adjuster strap are not twisted.



16 Cut paper tab, then remove and discard.

Britax
Childcare



First class travel for children

Britax Child Safety, Inc.
13501 South Ridge Drive
Charlotte, NC 28273
Consumer Services: 1-800-683-2045
For further information visit BritaxUSA.com
© 2004 Britax® Child Safety, Inc.
P247100 - R1:08/04